

# Welcome



Lightcloud®  
**Smart LED A19**

WE'RE HERE TO HELP:

**1(844) LIGHTCLOUD**

1(844) 554-4825

# Hello

Lightcloud is a wireless lighting control service. The Lightcloud Lamp is an intelligent lamp that connects wirelessly to a Lightcloud system to provide switching, dimming and scene control.

## Product Features

Wireless Control & Configuration

Zone Switching & Dimming

Human centric light spectrum

Power monitoring

CCT change

Smart shift ready

CRI > 95

# CAUTION

- Not suitable for use with dimmers and sensors unless specifically designed for RAB Lightcloud Lamps.
- Risk of electric shock
- Do not use where directly exposed to water.
- Not intended for use with emergency exit fixtures or emergency lights.
- Only install in operating environments between -4 °F and 104°F (-20°C to 40 °C).

WE'RE HERE TO HELP:

**1(844) LIGHTCLOUD**

1(844) 554-4825

# What You Need

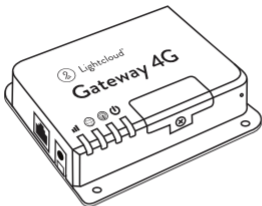

## Finding a suitable location

Lightcloud uses a wireless mesh network to connect devices such as the Lightcloud Lamp to the Gateway. Unlike a WiFi router, each Lightcloud device may connect another device to the network. If there is a clear line of sight between two Lightcloud devices, they can be placed up to 1000 feet apart. If the two devices are separated by ordinary drywall construction, try to keep them within 100 feet of each other. Brick, concrete and steel construction may require additional AC-powered Lightcloud devices to go around the obstruction. See the Deployment section of your Gateway for more information.

# Setup & Installation

① **Turn off power**

 **WARNING**

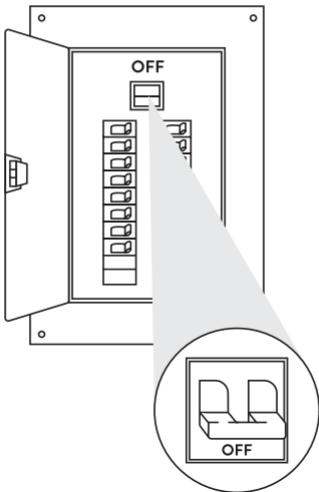

## ② Constant Power Required

Please remove all existing switches, dimmers, sensors, time clocks, or other control devices from all circuits with Lightcloud devices.

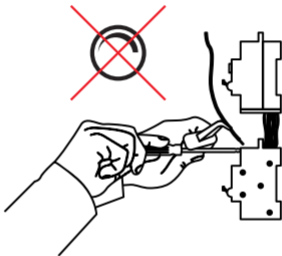

### ③ Install the Lightcloud Lamp

Screw in the Lightcloud lamp into the corresponding lamp base.

#### Pairing the Lamp

After screwing in, lamp will enter pairing mode automatically if it has not joined a gateway previously. Once gateway has been joined, lamp will indicate by flashing on and off 5 times and then dim to 30% brightness.



## Resetting the Lamp

### Method 1: 1-10 LAMPS Manual Reset

Power the lamp off and on 5 times consecutively. Do not allow more than 1 second to elapse between switching. The lamp will flash 3 times, then reset to 100% brightness at default CCT.



### Method 2: 10+ LAMPS Reset Tool

Reach out to your RAB sales manager to request a **Reset Tool**. The tool simply needs to be placed directly on the lamp for 2 seconds. The lamp will flash 3 times, then reset to 100% brightness at default CCT.



## ④ Labeling Your Device

When installing devices, it's important to keep track of their Device IDs, installation locations, panel/circuit #s, dimming function, and any additional notes. To organize this information, use the Lightcloud Installer Application (A) or Device Table (B).

### ④a Lightcloud Installer Application

#### **Install the LC Installer Application:**

LC Installer is available for iOS and Android.

#### **Scan & Install Lightcloud Devices:**

Scan each device and assign to a room. It's recommended that each device is scanned just before or just after being wired so no devices are missed. The more notes that are given, the easier it is to commission the system.

#### **Send to RAB:**

Once all of the devices have been added and organized, submit the information for commissioning.



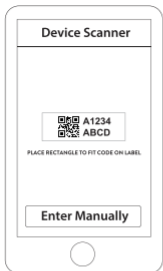

1. Scan Device Code



2. Enter Device Information



3. Repeat for Additional  
Devices

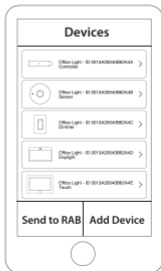

4. Send to RAB

## 4b Device Table

Two Lightcloud Device Tables are provided with each Gateway: one that you can attach to your panel and one to hand off to a building manager. Attach the Device Identification stickers included with each device to a row, then write in additional information, such as Zone name, Panel/Circuit Number, and whether or not a Zone uses dimming.

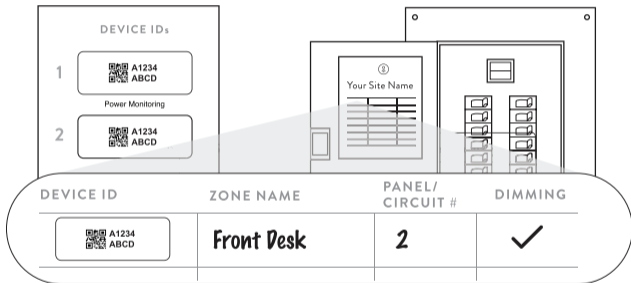

## 5 Power Up

To add devices to your Lightcloud network, call RAB at 1 (844) LIGHTCLOUD, or email us at [support@lightcloud.com](mailto:support@lightcloud.com)



Lightcloud is a commercial wireless lighting control system. It's powerful and flexible, yet easy to use and install. Learn more at [www.lightcloud.com](http://www.lightcloud.com)

1(844) LIGHTCLOUD  
1(844) 554-4825

**RAB<sup>®</sup>**

©2020 RAB LIGHTING Inc.

Made in China.

Pat. [rablighting.com/ip](http://rablighting.com/ip)

# Welcome



Lightcloud®

**Smart LED BR30**

WE'RE HERE TO HELP:

**1(844) LIGHTCLOUD**

1(844) 554-4825

# Hello

Lightcloud is a wireless lighting control service. The Lightcloud Lamp is an intelligent lamp that connects wirelessly to a Lightcloud system to provide switching, dimming and scene control.

## Product Features

Wireless Control & Configuration

Zone Switching & Dimming

Human centric light spectrum

Power monitoring

CCT change

Smart shift ready

CRI > 95

# CAUTION

- Not suitable for use with dimmers and sensors unless specifically designed for RAB Lightcloud Lamps.
- Risk of electric shock
- Do not use where directly exposed to water.
- Not intended for use with emergency exit fixtures or emergency lights.
- Only install in operating environments between -4 °F and 104°F(-20°C to 40 °C).

WE'RE HERE TO HELP:

**1(844) LIGHTCLOUD**

1(844) 554-4825

# What You Need

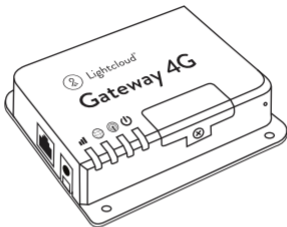

## Finding a suitable location

Lightcloud uses a wireless mesh network to connect devices such as the Lightcloud Lamp to the Gateway. Unlike a WiFi router, each Lightcloud device may connect another device to the network. If there is a clear line of sight between two Lightcloud devices, they can be placed up to 1000 feet apart. If the two devices are separated by ordinary drywall construction, try to keep them within 100 feet of each other. Brick, concrete and steel construction may require additional AC-powered Lightcloud devices to go around the obstruction. See the Deployment section of your Gateway for more information.

# Setup & Installation

① **Turn off power**

 **WARNING**

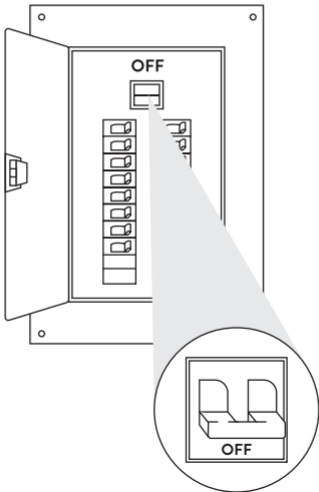



## ② Constant Power Required

Please remove all existing switches, dimmers, sensors, time clocks, or other control devices from all circuits with Lightcloud devices.

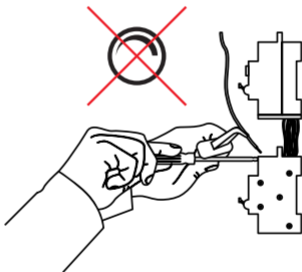

### 3 Install the Lightcloud Lamp

Screw in the Lightcloud lamp into the corresponding lamp base.

#### Pairing the Lamp

After screwing in, lamp will enter pairing mode automatically if it has not joined a gateway previously. Once gateway has been joined, lamp will indicate by flashing on and off 5 times and then dim to 30% brightness.

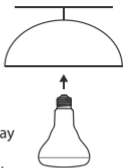

## Resetting the Lamp

### Method 1: 1-10 LAMPS Manual Reset

Power the lamp off and on 5 times consecutively. Do not allow more than 1 second to elapse between switching. The lamp will flash 3 times, then reset to 100% brightness at default CCT.



### Method 2: 10+ LAMPS Reset Tool

Reach out to your RAB sales manager to request a **Reset Tool**. The tool simply needs to be placed directly on the lamp for 2 seconds. The lamp will flash 3 times, then reset to 100% brightness at default CCT.



## ④ Labeling Your Device

When installing devices, it's important to keep track of their Device IDs, installation locations, panel/circuit #s, dimming function, and any additional notes. To organize this information, use the Lightcloud Installer Application (A) or Device Table (B).

### ④a Lightcloud Installer Application

#### **Install the LC Installer Application:**

LC Installer is available for iOS and Android.

#### **Scan & Install Lightcloud Devices:**

Scan each device and assign to a room. It's recommended that each device is scanned just before or just after being wired so no devices are missed. The more notes that are given, the easier it is to commission the system.

#### **Send to RAB:**

Once all of the devices have been added and organized, submit the information for commissioning.



1. Scan Device Code



2. Enter Device Information



3. Repeat for Additional Devices



4. Send to RAB

## 4b Device Table

Two Lightcloud Device Tables are provided with each Gateway: one that you can attach to your panel and one to hand off to a building manager. Attach the Device Identification stickers included with each device to a row, then write in additional information, such as Zone name, Panel/Circuit Number, and whether or not a Zone uses dimming.

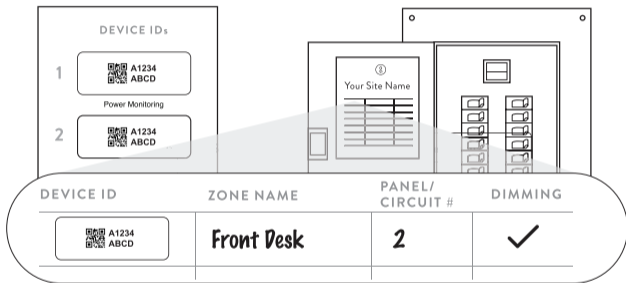

## 5 Power Up

To add devices to your Lightcloud network, call RAB at 1 (844) LIGHTCLOUD, or email us at [support@lightcloud.com](mailto:support@lightcloud.com)



Lightcloud is a commercial wireless lighting control system. It's powerful and flexible, yet easy to use and install. Learn more at [www.lightcloud.com](http://www.lightcloud.com)

1(844) LIGHTCLOUD  
1(844) 554-4825

**RAB**<sup>®</sup>

©2020 RAB LIGHTING Inc.

Made in China.

Pat. [rablighting.com/ip](http://rablighting.com/ip)

# Welcome



Lightcloud<sup>®</sup>

## Smart LED Post Top

WE'RE HERE TO HELP:

**1(844) LIGHTCLOUD**

1(844) 554-4825

# Hello

Lightcloud is a wireless lighting control service. The Lightcloud Lamp is an intelligent lamp that connects wirelessly to a Lightcloud system to provide switching, dimming and scene control.

## Product Features

Wireless Control & Configuration

Scheduling & Astronomical Clock

Switching & Dimming

Performs as Regular Lamp

When no Lightcloud module plugged in



# CAUTION

- These LED Lamps require all ballasts, capacitors, and ignitors to be bypassed or removed. Do not operate lamps on existing ballasts.
- Before installation make certain the AC power to the fixture is off.
- For use in enclosed fixtures.
- Risk of fire or electric shock. Luminaire wiring and electrical parts may be damaged when drilling for installation of LED retrofit kit. Check for enclosed wiring and components.
- Risk of fire or electric shock. LED Retrofit lamp installation requires knowledge of luminaires electrical systems. If not qualified, do not attempt installation. Contact a qualified electrician.
- Do not make or alter any open holes in an enclosure of wiring or electrical components during kit installation.
- Installers should not disconnect existing wires from lampholder terminals to make new connections at lampholder terminals. Instead installers should cut existing lampholder leads away from the lampholder and make new electrical connections to lampholder lead wires by employing applicable connectors.
- To prevent wiring damage or abrasion, do not expose wiring to edges of sheet metal or other sharp objects.
- Risk of fire or electric shock. Install this kit only in luminaires that have the construction features and dimensions shown in the photographs or drawings and where the input rating of the retrofit kit does not exceed the input rating of the luminaire.

- Added weight of the device may cause instability of a free-standing portable luminaire.
  - Not suitable for use with dimmers and sensors unless specifically designed for RAB Lightcloud Lamps.
  - Only install in operating environments between -22 °F and 140°F (-30°C to 60 °C).
- THIS RETROFIT KIT IS ACCEPTED AS A COMPONENT OF A LUMINAIRE WHERE THE SUITABILITY OF THE COMBINATION SHALL BE DETERMINED BY AUTHORITIES HAVING JURISDICTION.
- THIS PRODUCT MUST BE INSTALLED IN ACCORDANCE WITH THE APPLICABLE INSTALLATION CODE BY A PERSON FAMILIAR WITH THE CONSTRUCTION AND OPERATION OF THE PRODUCT AND THE HAZARDS INVOLVED.

WE'RE HERE TO HELP:

**1(844) LIGHTCLOUD**

**1(844) 554-4825**

# What You Need

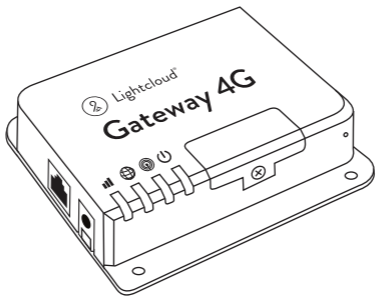

## Finding a suitable location

Lightcloud uses a wireless mesh network to connect devices such as the Lightcloud Lamp to the Gateway. Unlike a WiFi router, each Lightcloud device may connect another device to the network. If there is a clear line of sight between two Lightcloud devices, they can be placed up to 1000 feet apart. If the two devices are separated by ordinary drywall construction, try to keep them within 100 feet of each other. Brick, concrete and steel construction may require additional AC-powered Lightcloud devices to go around the obstruction. See the Deployment section of your Gateway for more information.

# Setup & Installation

## ① Turn off power



WARNING

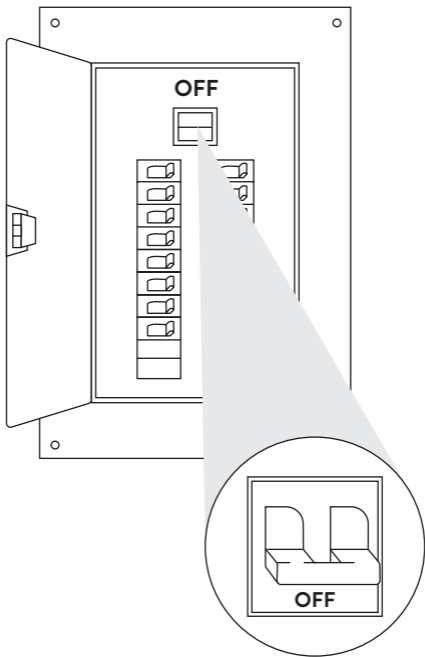

## ② Constant Power Required

Please remove all existing switches, dimmers, sensors, time clocks, or other control devices from all circuits with Lightcloud devices.

Smart Lamps require constant power and should not be controlled using traditional dimmers, switches, or other power-limiting devices. For manual control, use the Lightcloud App or install a Lightcloud Dimmer.

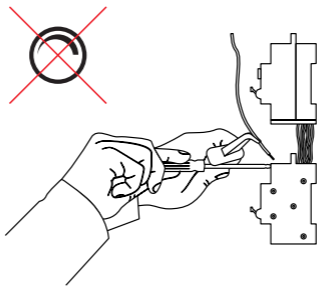

**Warning:** All wiring should be handled by a licensed professional.

### 3 Install the Lightcloud Lamp

**Step: 1** Turn off the power before installation. Remove old ballasts/dimmers from existing lampholder as shown in Figure 1.

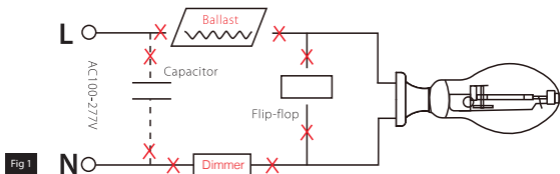

**Step: 2** Make sure the Alternating Current (AC) wires connect to the socket directly. Screw the Lightcloud lamp into the corresponding socket as shown in Figure 2. Attach retrofit label to luminaire (included in box). Plug the Lightcloud module securely into the auxiliary port on lamp as shown in Figure 3.

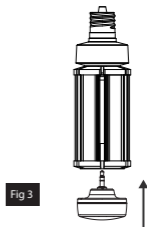
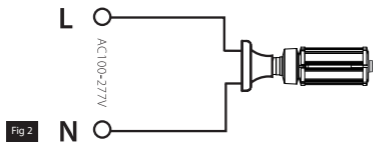

### Step: 3 Pairing the Lamp

Screw in the Lightcloud lamp into the corresponding lamp base. Figure 4. After screwing in, lamp will enter pairing mode automatically if it has not joined a gateway previously. Once gateway has been joined, lamp will indicate by flashing on and off 5 times and then dim to 30% brightness.

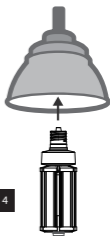

Fig 4

## Resetting the Lamp

### Method 1: **1-10 LAMPS** Manual Reset

Power the lamp off and on 5 times consecutively. Do not allow more than 10 seconds and less than 5 seconds to elapse between switching. The lamp will flash 3 times, then reset to 100% brightness.



### Method 2: **10+ LAMPS** Reset Tool

Reach out to your RAB sales manager to request a **Reset Tool**. The tool simply needs to be placed directly on the lamp for 2 seconds. The lamp will flash 3 times, then reset to 100% brightness at default CCT.



## ④ Labeling Your Device

When installing devices, it's important to keep track of their Device IDs, installation locations, panel/circuit #s, dimming function, and any additional notes. To organize this information, use the Lightcloud Installer Application (A) or Device Table (B).

### 4a Lightcloud Installer Application

#### **Install the LC Installer Application:**

LC Installer is available for iOS and Android.

#### **Scan & Install Lightcloud Devices:**

Scan each device and assign to a room. It's recommended that each device is scanned just before or just after being wired so no devices are missed. The more notes that are given, the easier it is to commission the system.

#### **Send to RAB:**

Once all of the devices have been added and organized, submit the information for commissioning.



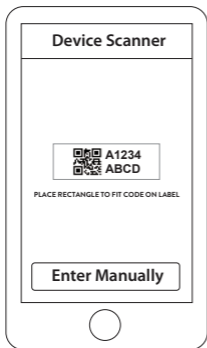

1. Scan Device Code

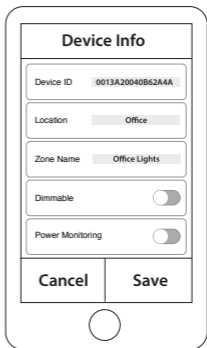

2. Enter Device Information



3. Repeat for Additional Devices

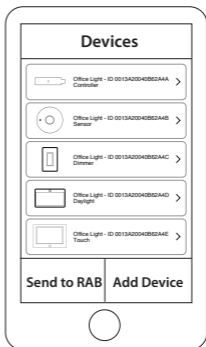

4. Send to RAB

## 4b Device Table

Two Lightcloud Device Tables are provided with each Gateway: one that you can attach to your panel and one to hand off to a building manager. Attach the Device Identification stickers included with each device to a row, then write in additional information, such as Zone name, Panel/Circuit Number, and whether or not a Zone uses dimming.

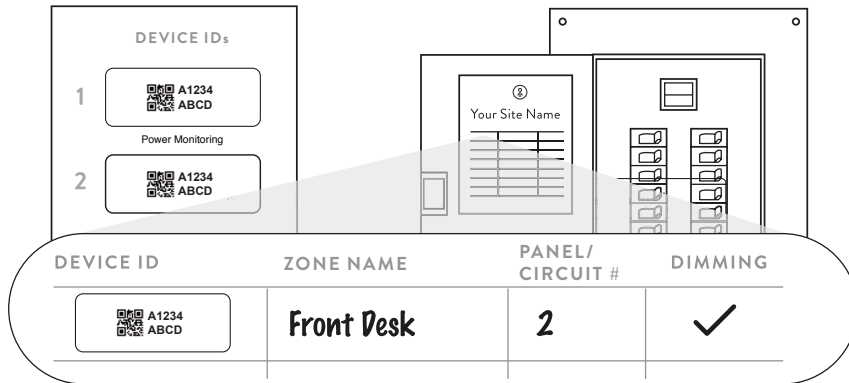

## 5 Power Up

To add devices to your Lightcloud network, call RAB at 1 (844) LIGHTCLOUD, or email us at [support@lightcloud.com](mailto:support@lightcloud.com)



Lightcloud is a commercial wireless lighting control system. It's powerful and flexible, yet easy to use and install.

Learn more at

[www.lightcloud.com](http://www.lightcloud.com)

1(844) LIGHTCLOUD

1(844) 554-4825

**RAB<sup>®</sup>**

©2020 RAB LIGHTING Inc.

Made in China

Pat. [rablighting.com/ip](http://rablighting.com/ip)

# Welcome



Lightcloud<sup>®</sup>

## Smart LED Post Top

WITH SENSOR

WE'RE HERE TO HELP:

**1(844) LIGHTCLOUD**

1(844) 554-4825

# Hello

Lightcloud is a wireless lighting control service. The Lightcloud Lamp is an intelligent lamp that connects wirelessly to a Lightcloud system to provide switching, dimming and scene control.

## Product Features

Wireless Control & Configuration

Scheduling & Astronomical Clock

Switching & Dimming

Motion Detection & Daylight Harvest

Performs as Regular Lamp

When no sensor plugged in

# CAUTION

- These LED Lamps require all ballasts, capacitors, and ignitors to be bypassed or removed. Do not operate lamps on existing ballasts.
- Before installation make certain the AC power to the fixture is off.
- Risk of fire or electric shock. Luminaire wiring and electrical parts may be damaged when drilling for installation of LED retrofit kit. Check for enclosed wiring and components.
- Risk of fire or electric shock. LED Retrofit lamp installation requires knowledge of luminaires electrical systems. If not qualified, do not attempt installation. Contact a qualified electrician.
- Do not make or alter any open holes in an enclosure of wiring or electrical components during kit installation.
- Installers should not disconnect existing wires from lampholder terminals to make new connections at lampholder terminals. Instead installers should cut existing lampholder leads away from the lampholder and make new electrical connections to lampholder lead wires by employing applicable connectors.
- To prevent wiring damage or abrasion, do not expose wiring to edges of sheet metal or other sharp objects.
- Risk of fire or electric shock. Install this kit only in luminaires that have the construction features and dimensions shown in the photographs or drawings and where the input rating of the retrofit kit does not exceed the input rating of the luminaire.

- Added weight of the device may cause instability of a free-standing portable luminaire.
- Not suitable for use with dimmers and sensors unless specifically designed for RAB Lightcloud Lamps.
- Lightcloud lamp only install in operating environments between -22 °F and 140°F (-30°C to 60 °C).  
PIR sensor perform operation temperature is between -4 °F and 95°F (-20°C to 35 °C).
- The Lightcloud Lamps are suitable for use in totally enclosed fixtures, while the PIR sensor function will be impacted in enclosed fixtures.
  
- THIS RETROFIT KIT IS ACCEPTED AS A COMPONENT OF A LUMINAIRE WHERE THE SUITABILITY OF THE COMBINATION SHALL BE DETERMINED BY AUTHORITIES HAVING JURISDICTION.
  
- THIS PRODUCT MUST BE INSTALLED IN ACCORDANCE WITH THE APPLICABLE INSTALLATION CODE BY A PERSON FAMILIAR WITH THE CONSTRUCTION AND OPERATION OF THE PRODUCT AND THE HAZARDS INVOLVED.

WE'RE HERE TO HELP:

**1(844) LIGHTCLOUD**

**1(844) 554-4825**

# What You Need

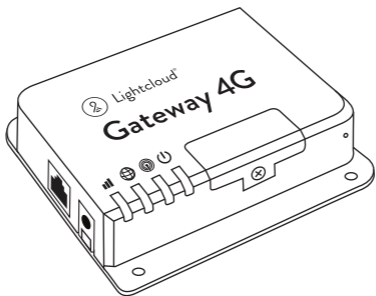

## Finding a suitable location

Lightcloud uses a wireless mesh network to connect devices such as the Lightcloud Lamp to the Gateway. Unlike a WiFi router, each Lightcloud device may connect another device to the network. If there is a clear line of sight between two Lightcloud devices, they can be placed up to 1000 feet apart. If the two devices are separated by ordinary drywall construction, try to keep them within 100 feet of each other. Brick, concrete and steel construction may require additional AC-powered Lightcloud devices to go around the obstruction. See the Deployment section of your Gateway for more information.



# Setup & Installation

## ① Turn off power

 WARNING

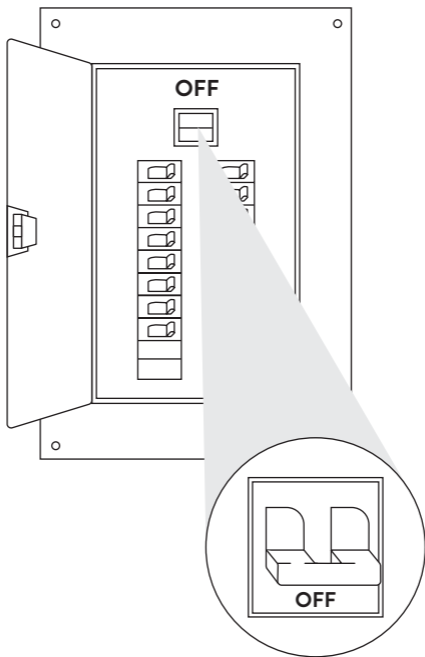

## ② Constant Power Required

Please remove all existing switches, dimmers, sensors, time clocks, or other control devices from all circuits with Lightcloud devices.

Smart Lamps require constant power and should not be controlled using traditional dimmers, switches, or other power-limiting devices. For manual control, use the Lightcloud App or install a Lightcloud Dimmer.

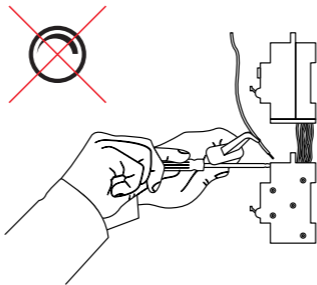

Warning: All wiring should be handled by a licensed professional.

### 3 Install the Lightcloud Lamp

**Step: 1** Turn off the power before installation. Remove old ballasts/dimmers from existing lampholder as shown in Figure 1.

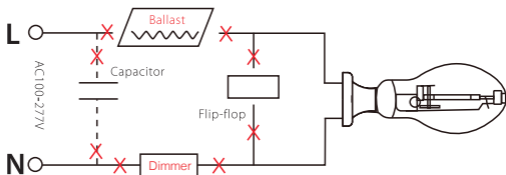

Fig 1

**Step: 2** Make sure the Alternating Current (AC) wires connect to the socket directly. Screw the Lightcloud lamp into the corresponding socket as shown in Figure 2. Attach retrofit label to luminaire (included in box). Plug the Lightcloud module securely into the auxiliary port on lamp as shown in Figure 3.

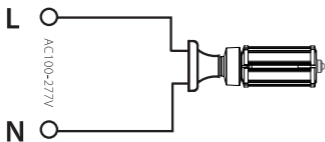

Fig 2



Fig 3

## Step: 3 Pairing the Lamp

Screw in the Lightcloud lamp into the corresponding lamp base. Figure 4. After screwing in, lamp will enter pairing mode automatically if it has not joined a gateway previously. Once gateway has been joined, lamp will indicate by flashing on and off 5 times and then dim to 30% brightness.

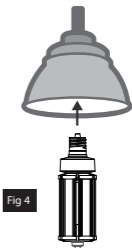

## Resetting the Lamp

### Method 1: 1-10 LAMPS Manual Reset

Power the lamp off and on 5 times consecutively. Do not allow more than 10 seconds and less than 5 seconds to elapse between switching. The lamp will flash 3 times, then reset to 100% brightness.



### Method 2: 10+ LAMPS Reset Tool

Reach out to your RAB sales manager to request a **Reset Tool**. The tool simply needs to be placed directly on the lamp for 2 seconds. The lamp will flash 3 times, then reset to 100% brightness at default CCT.



## ④ Labeling Your Device

When installing devices, it's important to keep track of their Device IDs, installation locations, panel/circuit #s, dimming function, and any additional notes. To organize this information, use the Lightcloud Installer Application (A) or Device Table (B).

### ④a Lightcloud Installer Application

#### **Install the LC Installer Application:**

LC Installer is available for iOS and Android.

#### **Scan & Install Lightcloud Devices:**

Scan each device and assign to a room. It's recommended that each device is scanned just before or just after being wired so no devices are missed. The more notes that are given, the easier it is to commission the system.

#### **Send to RAB:**

Once all of the devices have been added and organized, submit the information for commissioning.



1. Scan Device Code

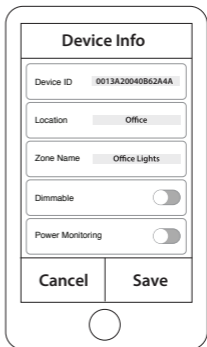

2. Enter Device Information



3. Repeat for Additional Devices

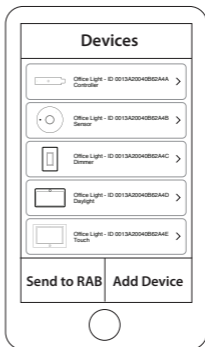

4. Send to RAB

## 4b Device Table

Two Lightcloud Device Tables are provided with each Gateway: one that you can attach to your panel and one to hand off to a building manager. Attach the Device Identification stickers included with each device to a row, then write in additional information, such as Zone name, Panel/Circuit Number, and whether or not a Zone uses dimming.

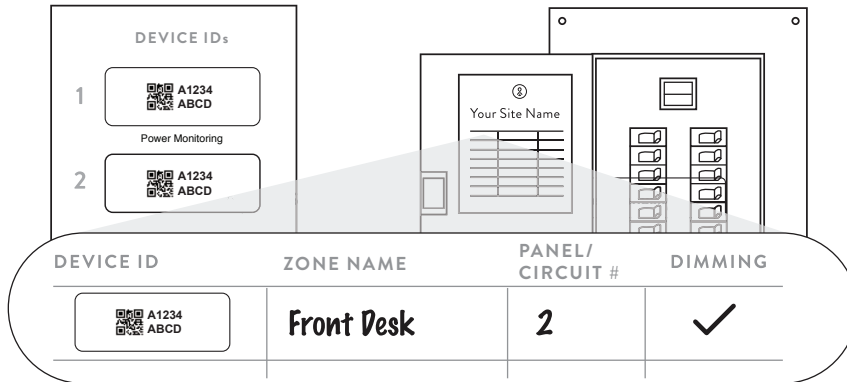

## 5 Power Up

To add devices to your Lightcloud network, call RAB at 1 (844) LIGHTCLOUD, or email us at [support@lightcloud.com](mailto:support@lightcloud.com)



Lightcloud is a commercial wireless lighting control system. It's powerful and flexible, yet easy to use and install. Learn more at [www.lightcloud.com](http://www.lightcloud.com)

1(844) LIGHTCLOUD  
1(844) 554-4825

**RAB<sup>®</sup>**

©2020 RAB LIGHTING Inc.

Made in China

Pat. [rablighting.com/ip](http://rablighting.com/ip)



# Welcome



Lightcloud<sup>®</sup>  
Smart LED High Bay

WE'RE HERE TO HELP:

**1(844) LIGHTCLOUD**

1(844) 554-4825

# Hello

Lightcloud is a wireless lighting control service. The Lightcloud Lamp is an intelligent lamp that connects wirelessly to a Lightcloud system to provide switching, dimming and scene control.

## Product Features

Wireless Control & Configuration

Scheduling & Astronomical Clock

Switching & Dimming

Performs as Regular Lamp

When no Lightcloud module plugged in

# CAUTION

- These LED Lamps require all ballasts, capacitors, and ignitors to be bypassed or removed. Do not operate lamps on existing ballasts.
- Before installation make certain the AC power to the fixture is off.
- For use in enclosed fixtures.
- Risk of fire or electric shock. Luminaire wiring and electrical parts may be damaged when drilling for installation of LED retrofit kit. Check for enclosed wiring and components.
- Risk of fire or electric shock. LED Retrofit lamp installation requires knowledge of luminaires electrical systems. If not qualified, do not attempt installation. Contact a qualified electrician.
- Do not make or alter any open holes in an enclosure of wiring or electrical components during kit installation.
- Installers should not disconnect existing wires from lampholder terminals to make new connections at lampholder terminals. Instead installers should cut existing lampholder leads away from the lampholder and make new electrical connections to lampholder lead wires by employing applicable connectors.
- To prevent wiring damage or abrasion, do not expose wiring to edges of sheet metal or other sharp objects.
- Risk of fire or electric shock. Install this kit only in luminaires that have the construction features and dimensions shown in the photographs or drawings and where the input rating of the retrofit kit does not exceed the input rating of the luminaire.

- Added weight of the device may cause instability of a free-standing portable luminaire.
- Not suitable for use with dimmers and sensors unless specifically designed for RAB Lightcloud Lamps.
- Only install in operating environments between -22 °F and 140°F (-30°C to 60 °C).
  
- THIS RETROFIT KIT IS ACCEPTED AS A COMPONENT OF A LUMINAIRE WHERE THE SUITABILITY OF THE COMBINATION SHALL BE DETERMINED BY AUTHORITIES HAVING JURISDICTION.
  
- THIS PRODUCT MUST BE INSTALLED IN ACCORDANCE WITH THE APPLICABLE INSTALLATION CODE BY A PERSON FAMILIAR WITH THE CONSTRUCTION AND OPERATION OF THE PRODUCT AND THE HAZARDS INVOLVED.

WE'RE HERE TO HELP:

**1(844) LIGHTCLOUD**

**1(844) 554-4825**

# What You Need

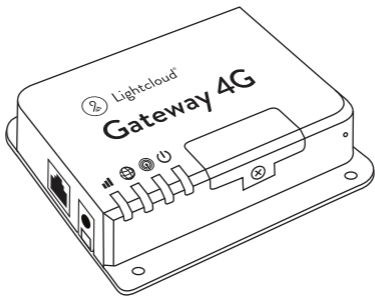

## Finding a suitable location

Lightcloud uses a wireless mesh network to connect devices such as the Lightcloud Lamp to the Gateway. Unlike a WiFi router, each Lightcloud device may connect another device to the network. If there is a clear line of sight between two Lightcloud devices, they can be placed up to 1000 feet apart. If the two devices are separated by ordinary drywall construction, try to keep them within 100 feet of each other. Brick, concrete and steel construction may require additional AC-powered Lightcloud devices to go around the obstruction. See the Deployment section of your Gateway for more information.

# Setup & Installation

① Turn off power



WARNING

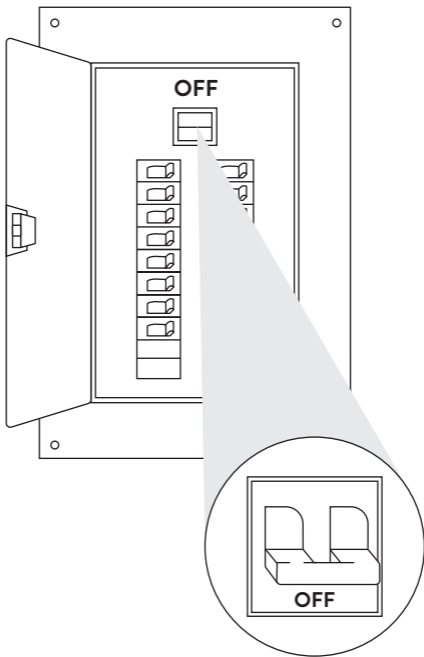

## ② Constant Power Required

Please remove all existing switches, dimmers, sensors, time clocks, or other control devices from all circuits with Lightcloud devices.

Smart Lamps require constant power and should not be controlled using traditional dimmers, switches, or other power-limiting devices. For manual control, use the Lightcloud App or install a Lightcloud Dimmer.

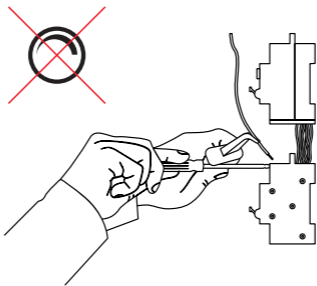

**Warning:** All wiring should be handled by a licensed professional.

### 3 Install the Lightcloud Lamp

**Step: 1** Turn off the power before installation. Remove old ballasts/dimmers from existing lampholder as shown in Figure 1.

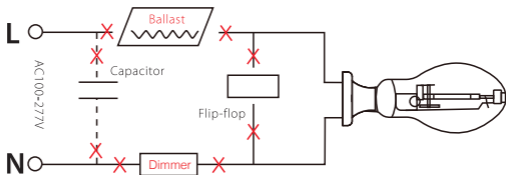

Fig 1

**Step: 2** Make sure the Alternating Current (AC) wires connect to the socket directly. Screw the Lightcloud lamp into the corresponding socket as shown in Figure 2. Attach retrofit label to luminaire (included in box). Plug the Lightcloud module securely into the auxiliary port on lamp as shown in Figure 3

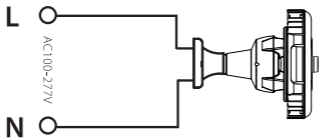

Fig 2

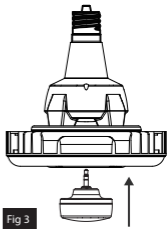
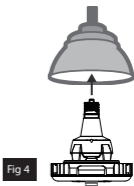

Fig 3



## Step: 3 Pairing the Lamp

Screw in the Lightcloud lamp into the corresponding lamp base. Figure 4. After screwing in, lamp will enter pairing mode automatically if it has not joined a gateway previously. Once gateway has been joined, lamp will indicate by flashing on and off 5 times and then dim to 30% brightness.



## Safety Cable

The safety cable must be used when installing the lamp to prevent the lamp from falling should the older socket fail. Figure 5.



## Resetting the Lamp

### Method 1: **1-10 LAMPS** Manual Reset

Power the lamp off and on 5 times consecutively. Do not allow more than 10 seconds and less than 5 seconds to elapse between switching. The lamp will flash 3 times, then reset to 100% brightness.



### Method 2: **10+ LAMPS** Reset Tool

Reach out to your RAB sales manager to request a **Reset Tool**. The tool simply needs to be placed directly on the lamp for 2 seconds. The lamp will flash 3 times, then reset to 100% brightness at default CCT.



## ④ Labeling Your Device

When installing devices, it's important to keep track of their Device IDs, installation locations, panel/circuit #s, dimming function, and any additional notes. To organize this information, use the Lightcloud Installer Application (A) or Device Table (B).

### ④a Lightcloud Installer Application

#### **Install the LC Installer Application:**

LC Installer is available for iOS and Android.

#### **Scan & Install Lightcloud Devices:**

Scan each device and assign to a room. It's recommended that each device is scanned just before or just after being wired so no devices are missed. The more notes that are given, the easier it is to commission the system.

#### **Send to RAB:**

Once all of the devices have been added and organized, submit the information for commissioning.



1. Scan Device Code

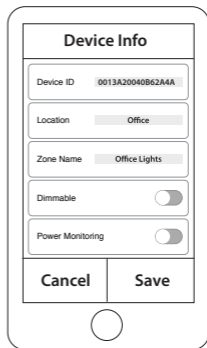

2. Enter Device Information



3. Repeat for Additional Devices

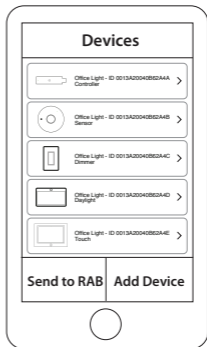

4. Send to RAB

## 4b Device Table

Two Lightcloud Device Tables are provided with each Gateway: one that you can attach to your panel and one to hand off to a building manager. Attach the Device Identification stickers included with each device to a row, then write in additional information, such as Zone name, Panel/Circuit Number, and whether or not a Zone uses dimming.

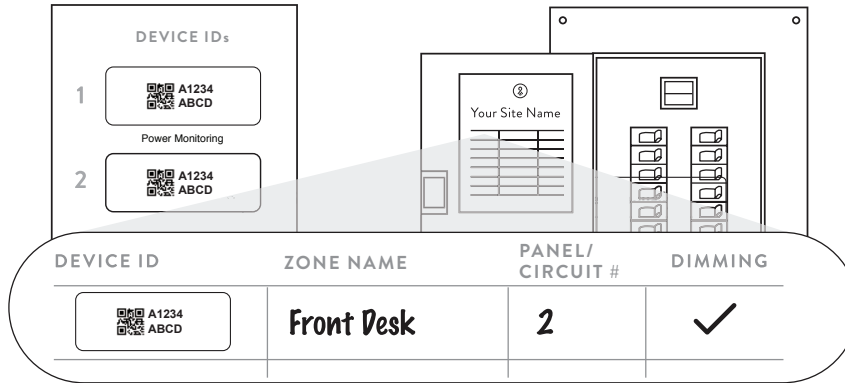

## 5 Power Up

To add devices to your Lightcloud network, call RAB at 1 (844) LIGHTCLOUD, or email us at [support@lightcloud.com](mailto:support@lightcloud.com)



Lightcloud is a commercial wireless lighting control system. It's powerful and flexible, yet easy to use and install. Learn more at [www.lightcloud.com](http://www.lightcloud.com)

1(844) LIGHTCLOUD  
1(844) 554-4825

**RAB**<sup>®</sup>

©2020 RAB LIGHTING Inc.

Made in China

Pat. [rablighting.com/ip](http://rablighting.com/ip)

# Welcome



Lightcloud<sup>®</sup>

## Smart LED High Bay

WITH SENSOR

WE'RE HERE TO HELP:

**1(844) LIGHTCLOUD**

1(844) 554-4825

# Hello

Lightcloud is a wireless lighting control service. The Lightcloud Lamp is an intelligent lamp that connects wirelessly to a Lightcloud system to provide switching, dimming and scene control.

## Product Features

Wireless Control & Configuration

Scheduling & Astronomical Clock

Switching & Dimming

Motion Detection & Daylight Harvest

Performs as Regular Lamp

When no sensor plugged in

# CAUTION

- These LED Lamps require all ballasts, capacitors, and ignitors to be bypassed or removed. Do not operate lamps on existing ballasts.
- Before installation make certain the AC power to the fixture is off.
- Risk of fire or electric shock. Luminaire wiring and electrical parts may be damaged when drilling for installation of LED retrofit kit. Check for enclosed wiring and components.
- Risk of fire or electric shock. LED Retrofit lamp installation requires knowledge of luminaires electrical systems. If not qualified, do not attempt installation. Contact a qualified electrician.
- Do not make or alter any open holes in an enclosure of wiring or electrical components during kit installation.
- Installers should not disconnect existing wires from lampholder terminals to make new connections at lampholder terminals. Instead installers should cut existing lampholder leads away from the lampholder and make new electrical connections to lampholder lead wires by employing applicable connectors.
- To prevent wiring damage or abrasion, do not expose wiring to edges of sheet metal or other sharp objects.
- Risk of fire or electric shock. Install this kit only in luminaires that have the construction features and dimensions shown in the photographs or drawings and where the input rating of the retrofit kit does not exceed the input rating of the luminaire.



- Added weight of the device may cause instability of a free-standing portable luminaire.
- Not suitable for use with dimmers and sensors unless specifically designed for RAB Lightcloud Lamps.
- Lightcloud lamp only install in operating environments between -22 °F and 140°F (-30°C to 60 °C).  
PIR sensor perform operation temperature is between -4 °F and 95°F (-20°C to 35 °C).
- The Lightcloud Lamps are suitable for use in totally enclosed fixtures, while the PIR sensor function will be impacted in enclosed fixtures.
- THIS RETROFIT KIT IS ACCEPTED AS A COMPONENT OF A LUMINAIRE WHERE THE SUITABILITY OF THE COMBINATION SHALL BE DETERMINED BY AUTHORITIES HAVING JURISDICTION.
- THIS PRODUCT MUST BE INSTALLED IN ACCORDANCE WITH THE APPLICABLE INSTALLATION CODE BY A PERSON FAMILIAR WITH THE CONSTRUCTION AND OPERATION OF THE PRODUCT AND THE HAZARDS INVOLVED.

WE'RE HERE TO HELP:

**1(844) LIGHTCLOUD**

**1(844) 554-4825**

# What You Need

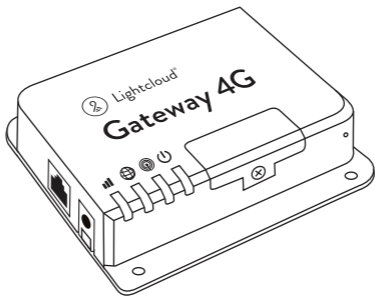

## Finding a suitable location

Lightcloud uses a wireless mesh network to connect devices such as the Lightcloud Lamp to the Gateway. Unlike a WiFi router, each Lightcloud device may connect another device to the network. If there is a clear line of sight between two Lightcloud devices, they can be placed up to 1000 feet apart. If the two devices are separated by ordinary drywall construction, try to keep them within 100 feet of each other. Brick, concrete and steel construction may require additional AC-powered Lightcloud devices to go around the obstruction. See the Deployment section of your Gateway for more information.

# Setup & Installation

① **Turn off power**



**WARNING**

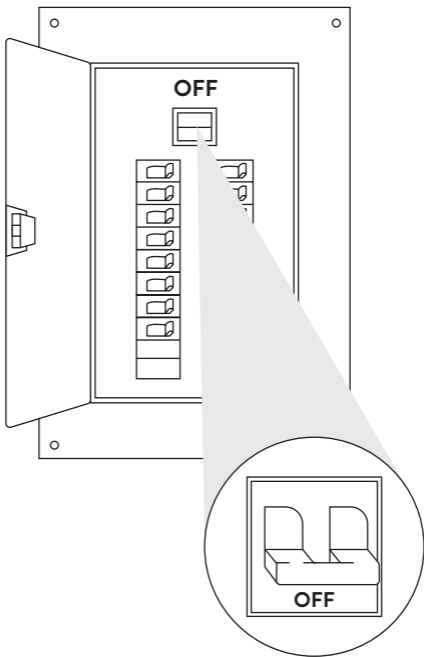

## ② Constant Power Required

Please remove all existing switches, dimmers, sensors, time clocks, or other control devices from all circuits with Lightcloud devices.

Smart Lamps require constant power and should not be controlled using traditional dimmers, switches, or other power-limiting devices. For manual control, use the Lightcloud App or install a Lightcloud Dimmer.

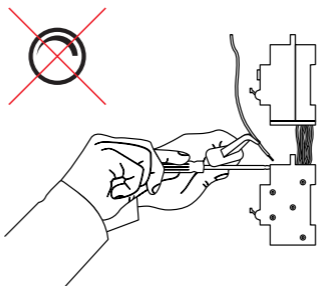

**Warning:** All wiring should be handled by a licensed professional.

### 3 Install the Lightcloud Lamp

**Step: 1** Turn off the power before installation. Remove old ballasts/dimmers from existing lampholder as shown in Figure 1.

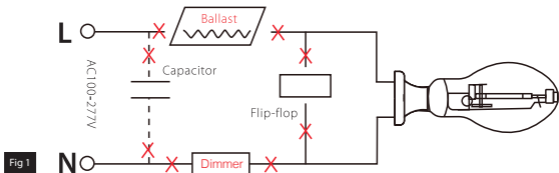

Fig 1

**Step: 2** Make sure the Alternating Current (AC) wires connect to the socket directly. Screw the Lightcloud lamp into the corresponding socket as shown in Figure 2. Attach retrofit label to luminaire (included in box). Plug the Lightcloud module securely into the auxiliary port on lamp as shown in Figure 3.

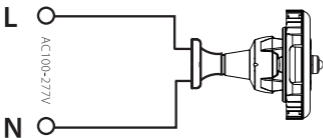

Fig 2

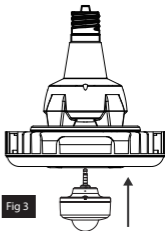

Fig 3

## Step: 3 Pairing the Lamp

Screw in the Lightcloud lamp into the corresponding lamp base. Figure 4. After screwing in, lamp will enter pairing mode automatically if it has not joined a gateway previously. Once gateway has been joined, lamp will indicate by flashing on and off 5 times and then dim to 30% brightness.



Fig 4

## Safety Cable

The safety cable must be used when installing the lamp to prevent the lamp from falling should the older socket fail. Figure 5.



Fig 5

## Resetting the Lamp

### Method 1: 1-10 LAMPS Manual Reset

Power the lamp off and on 5 times consecutively. Do not allow more than 10 seconds and less than 5 seconds to elapse between switching. The lamp will flash 3 times, then reset to 100% brightness.



### Method 2: 10+ LAMPS Reset Tool

Reach out to your RAB sales manager to request a **Reset Tool**. The tool simply needs to be placed directly on the lamp for 2 seconds. The lamp will flash 3 times, then reset to 100% brightness at default CCT.



## ④ Labeling Your Device

When installing devices, it's important to keep track of their Device IDs, installation locations, panel/circuit #s, dimming function, and any additional notes. To organize this information, use the Lightcloud Installer Application (A) or Device Table (B).

### ④a Lightcloud Installer Application

#### **Install the LC Installer Application:**

LC Installer is available for iOS and Android.

#### **Scan & Install Lightcloud Devices:**

Scan each device and assign to a room. It's recommended that each device is scanned just before or just after being wired so no devices are missed. The more notes that are given, the easier it is to commission the system.

#### **Send to RAB:**

Once all of the devices have been added and organized, submit the information for commissioning.



1. Scan Device Code

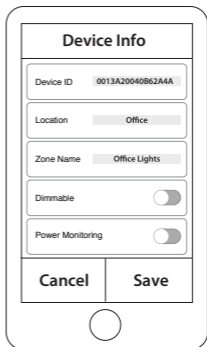

2. Enter Device Information



3. Repeat for Additional Devices

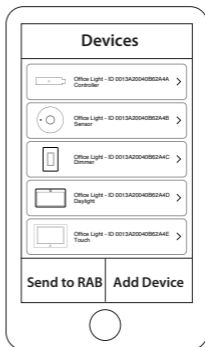

4. Send to RAB



## 4b Device Table

Two Lightcloud Device Tables are provided with each Gateway: one that you can attach to your panel and one to hand off to a building manager. Attach the Device Identification stickers included with each device to a row, then write in additional information, such as Zone name, Panel/Circuit Number, and whether or not a Zone uses dimming.

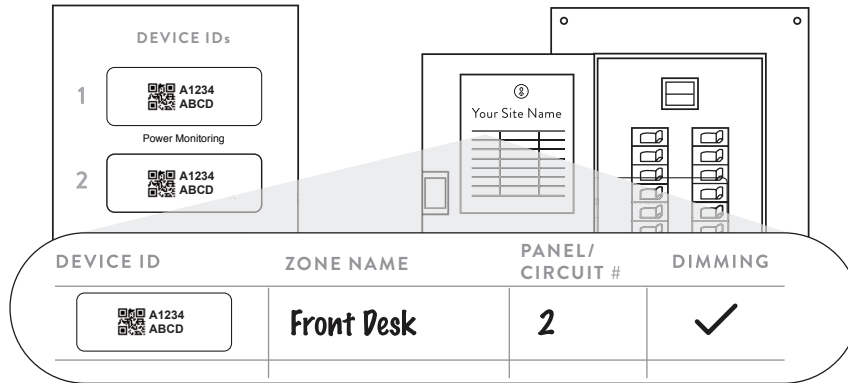

## 5 Power Up

To add devices to your Lightcloud network, call RAB at 1 (844) LIGHTCLOUD, or email us at [support@lightcloud.com](mailto:support@lightcloud.com)



Lightcloud is a commercial wireless lighting control system. It's powerful and flexible, yet easy to use and install. Learn more at

[www.lightcloud.com](http://www.lightcloud.com)

1(844) LIGHTCLOUD

1(844) 554-4825

**RAB**<sup>®</sup>

©2020 RAB LIGHTING Inc.

Made in China

Pat. [rablighting.com/ip](http://rablighting.com/ip)