

LF17X2 Field-Adjustable Landscape Light



LF17X2



PROJECT:

DATE:

TYPE:

PREPARED BY:

LF17X2/SMS



KEY FEATURES

- Adjustable wattages: 16/10/8/5/3W (8W default)
- CCT: adjustable 2700/3000/3500/4000/5000K (4000K default)
- Adjustable **Knuckle** arm
- Available in **bronze, white** and **black** finish
- UL listed for **wet location**
- **IP65** rated
- 120V
- **0-10V** dimmable
- 5-Year limited warranty

Field-adjustable floodlight



PERFORMANCE

LF17X2 16W	2700K	3000K	3500K	4000K	5000K	LF17X2 10W	2700K	3000K	3500K	4000K	5000K
Wattage	16W					Wattage	10W				
Input Watts	16.0W	15.8W	15.6W	15.4W	15.8W	Input Watts	10.8W	10.8W	10.6W	10.6W	10.8W
Lumens	1,992	2,046	2,152	2,230	2,210	Lumens	1,414	1,462	1,522	1,576	1,574
Lm/W	124.5	129.5	137.9	144.8	139.9	Lm/W	130.9	135.4	143.6	148.7	145.7
CRI	84	84	85	85	83	CRI	84	85	85	85	83
Voltage Rating	120V					Voltage Rating	120V				

LF17X2 8W	2700K	3000K	3500K	4000K	5000K	LF17X2 5W	2700K	3000K	3500K	4000K	5000K
Wattage	8W					Wattage	5W				
Input Watts	7.6W	7.6W	7.6W	7.4W	7.6W	Input Watts	4.6W	4.6W	4.6W	4.6W	4.6W
Lumens	1,012	1,044	1,094	1,106	1,130	Lumens	594	612	638	658	666
Lm/W	133.2	137.4	143.9	149.5	148.7	Lm/W	129.1	133.0	138.7	143.0	144.8
CRI	84	85	85	85	83	CRI	85	85	85	85	84
Voltage Rating	120V					Voltage Rating	120V				

LF17X2 3W	2700K	3000K	3500K	4000K	5000K
Wattage	3W				
Input Watts	3.0W	3.0W	3.0W	3.0W	3.0W
Lumens	358	366	380	390	400
Lm/W	119.3	122.0	126.7	130.0	133.3
CRI	85	85	85	85	84
Voltage Rating	120V				

LF17X2 Field-Adjustable Landscape Light



TECHNICAL SPECIFICATIONS

COMPLIANCE

UL Listed

Suitable for wet locations

LED CHARACTERISTICS

LEDs

Long-life, high-efficacy, surface-mount LEDs

Color Uniformity

RAB's range of Correlated Color Temperature follows the guidelines of the American National Standards for Specifications for the Chromaticity of Solid State Lighting (SLL) Products, ANSI C78.377-2017.

Color Consistency

7-step MacAdam Ellipse binning to achieve consistent fixture-to-fixture color.

CONSTRUCTION

Cold Weather Starting

Minimum starting temperature is -40°C (-40°F)

Maximum Ambient Temperature

Suitable for use in up to 40°C (104°F)

Housing

Die-cast aluminum

Mounting

Knuckle arm

Tilt Increment

10°

Lens

Polymethyl methacrylate

Gaskets

O-ring silicone

Green Technology

Mercury and UV free. RoHS-compliant components.

Finish

Formulated for high durability and long lasting color. Available in black, bronze & white finish.

IP Rating

Ingress protection of IP65 for dust and water

ELECTRICAL

Drivers:

Constant Current, Class P, 120V, 50/60 Hz

LF17X2 and LF17XE/SMS

16W: 120V: 0.14A

10W: 120V: 0.09A

8W: 120V: 0.07A

5W: 120V: 0.04A

3W: 120V: 0.03A

Surge Protection

2.5kV

Dimming Driver:

Driver includes dimming control wiring for 0-10V dimming systems. Requires separate 0-10V DC dimming circuit. Dims down to 10%.

THD (factory default):

16W: 120V: 6.94%

Power Factor (factory default):

16W: 120V: 99.7%

Note: All values are typical (tolerance +/- 10%)

FACTORY DEFAULT

CCT: Adjustable(2700/3000/3500/4000/5000K) default: 4000K

Wattage: Adjustable (16/10/8/5/3W) default: 8W

OPTIONAL MINI SENSOR (SMS500)

Electrical

Voltage: 120V AC 60Hz

Manual Override: Double flip wall switch logic prevents activation by brief power outages. Resets after 6 hours. No extra wiring needed.

Surge Protection: Withstands up to 3000 volts

RF Immunity: Circuits fully shielded for maximum radio frequency immunity

Incandescent Watts Switched: 500W @ 120 volts

Fluorescent Watts Switched: 250W @ 120 volts

Ratings: 5 amps

Power Consumption: Negligible

Manual Switch: None

Switching Capacity: Relay On/Off Model Switches 240W when lights are mounted to sensor. 500W Incandescent or 240W Fluorescent of remotely mounted lighting @ 120 volts.

Sensor Settings

Time Adjustment: 5 seconds to 15 minutes

Quick Test Time: 5 second test time for fast installation. Works day or night.

"No Hands" Auto Testing: Auto mode starts after 4 minutes of testing. No adjustment needed.

Photoelectric Control: Deactivates lights during daylight. Fully adjustable for 24 hour operation or custom applications.

Time Delay: 5 seconds to 15 minutes

Ambient Light Sensing: Adjustable

Adjustments: Time, ambient light & sensitivity

Detection: 180° detection pattern

PERFORMANCE

Lifespan

50,000-hour LED lifespan based on IES LM-80 results and TM-21 calculations

OTHER

Warranty

The RAB 5-year, limited warranty covers light output, driver performance and paint finish. RAB's warranty is subject to all terms and conditions found at rablighting.com/warranty.

LF17X2 Field-Adjustable Landscape Light



DIMENSIONS

LF17X2 W/ SMS500

Weight 2.65 lbs

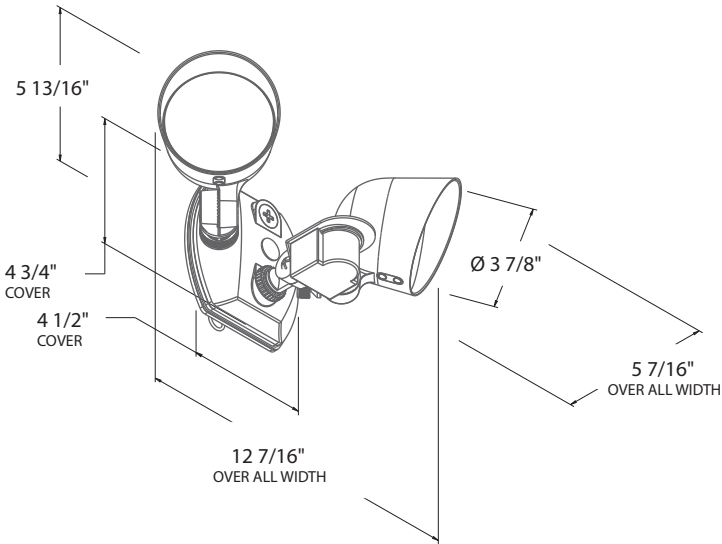

LF17X2

Weight 2.43 lbs

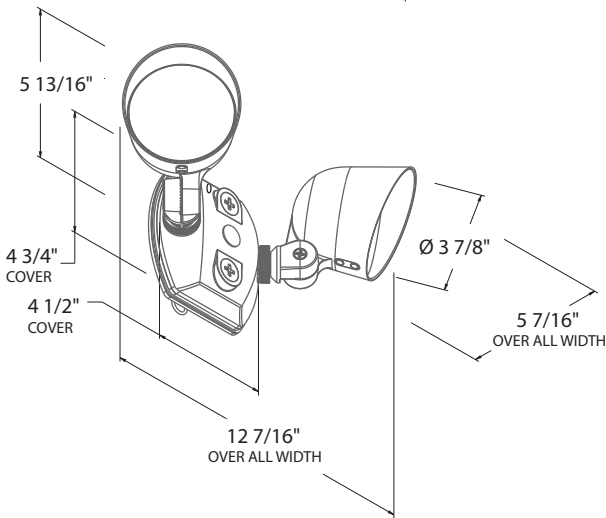

ORDERING MATRIX

LF17X2

Family	Wattages	Mounting	Color Temperature	Finish	Driver	Control
LF17X2						
BLANK	16/10/8/5/3W	BLANK Knuckle Arm	BLANK 2700/3000/3500/4000/5000K CCT Adjustable	BLANK W B Bronze White Black	BLANK /SMS 120V, 0-10V Dimming SMS500 Motion Sensor	BLANK /SMS None SMS500 Motion Sensor