

# Lightcloud Blue, Smartshift, SWISH® Center Basket Troffer



2'X2'



2'X4'



PROJECT:

DATE:

TYPE:

PREPARED BY:



## KEY FEATURES

- Available in two sizes & selectable wattages:  
SWISHFA2X2: 39/29/19W  
2X4: 49/39/29W
- CCT: 3500/4000/5000K selectable
- Also available with static wattage and tunable white 2700-6500K. Fully dimmable using the Lightcloud Blue app.  
2X2: 40W  
2X4: 50W
- Battery backup option offered
- Available with Microwave and passive infrared occupancy sensors
- Available with network wireless lighting control
- 5-year, no-compromise warranty

## Field-Adjustable and Tunable White Center Basket



## PERFORMANCE

SWISHFA2X2	3500K	4000K	5000K	3500K	4000K	5000K	3500K	4000K	5000K
INPUT WATTS	39W			29W			19W		
LUMENS	4,463	4,913	4,691	3,677	3,954	3,816	2,432	2,573	2,529
LM/W	116	133	122	123	136	128	129	139	134
CRI	83	85	84	84	85	84	84	86	84
VOLTAGE RATINGS	120-277V								

SWISHFA2X4	3500K	4000K	5000K	3500K	4000K	5000K	3500K	4000K	5000K
INPUT WATTS	49W			39W			29W		
LUMENS	5,702	5,882	5,806	4,875	5,263	5,072	3,484	3,677	3,624
LM/W	119	137	125	125	139	130	133	144	138
CRI	83	85	84	84	85	84	84	85	84
VOLTAGE RATINGS	120-277V								

SWISHFA2X2 SS 40W	Tunable 2700-6500K
INPUT WATTS	40W
LUMENS	4,400
LM/W	110.0
CRI	>80
VOLTAGE RATINGS	120-277V

SWISHFA2X4 SS 50W	Tunable 2700-6500K
INPUT WATTS	50W
LUMENS	5,500
LM/W	110.0
CRI	>80
VOLTAGE RATINGS	120-277V

## TECHNICAL SPECIFICATIONS

### COMPLIANCE

**UL Listed**

Suitable for dry and damp locations

**FCC Compliant**

Complies with part 15 of the FCC rules

**RoHS compliant**

Mercury and UV free

**IESNA LM-79 & LM-80 testing**

Components have been tested by an independent laboratory in accordance with IESNA LM-79 & LM-80

**DLC**

This product is on the Design Lights Consortium (DLC) Qualified Products List and is eligible for rebates from DLC Member Utilities. Designed to meet DLC 5.1 requirements.

SWISHFA2X2: PD0NA0YP

SWISHFA2X4: P7UHVH0

### FIELD-ADJUSTABILITY

**Field Adjustable:**

2'x2': 19W/29W/39W (factory default 29W)

2'x4': 29W/39W/49W (factory default: 39W)

Color temperature: Selectable by 3500/4000/5000K (factory default 4000K)

**Tunable White:**

2'x2': 40W

2'x4': 50W

Color temperature: Tunable 2700-6500K (Default 3000K)

### CONSTRUCTION

**Cold Weather Starting Temperature**

Minimum starting temperature is -20°C (-4°F)

**Maximum Ambient Temperature**

Suitable for use in up to 40°C (104°F)

**Mounting**

Recessed into T-grid ceiling. Surface and recessed mounting kits for drywall ceilings, sold separately

**Lens**

Frosted Polystyrene

**Housing / Finish**

Sheet metal and extruded aluminum / White

**Green Technology**

Mercury and UV free. RoHS-compliant components

**Reflector:**

Aluminum with high reflectance white finish, optimized for uniform distribution

**Finish**

Formulated for high durability and long lasting color

### LED CHARACTERISTICS

**LEDs**

Long-life, high-efficacy, discrete, surface-mount LEDs

**Color Stability**

LED color temperature is warrantied to shift no more than 200K in color temperature over a 5-year period

### ELECTRICAL

**Drivers:****SWISHFA:**

Class 2, Constant Current, 120-277V, 50/60Hz

19W: 120V: 0.16A, 208V: 0.10A, 240V: 0.08A, 277V: 0.07A

29W: 120V: 0.25A, 208V: 0.15A, 240V: 0.13A, 277V: 0.12A

39W: 120V: 0.33A, 208V: 0.20A, 240V: 0.17A, 277V: 0.15A

49W: 120V: 0.39A, 208V: 0.24A, 240V: 0.21A, 277V: 0.17A

**SWISHFA SS (Color Tunable):**

Class 2, Constant Current, 120-277V, 50/60Hz

**40W:** 120V: 0.37A, 208V: 0.22A, 240V: 0.19A, 277V: 0.17A

**50W:** 120V: 0.45A, 208V: 0.26A, 240V: 0.23A, 277V: 0.21A

**Dimming Driver \*:**

Driver includes dimming control wiring for 0-10V dimming systems. Requires separate 0-10V DC dimming circuit. Dims down to 10%

(\* Dimming specs does not apply to the LCB version models)

**THD:**

2'x2': 4.65% at 120V, 16.05% at 277V

2'x4': 2.93% at 120V, 5.63% at 277V

**Power Factor:**

2'x2': 99.8% at 120V, 97.4% at 277V

2'x4': 99.69% at 120V, 95.2% at 277V

**Battery Backup:**

Battery backup will operate the LED Lamp for 90 minutes if power falls. Wired for 120-277V.

**Battery Backup Light Loss Factor:**

2'x2':

19W: 0.50

29W: 0.33

39W: 0.26

2'x4':

29W: 0.67

39W: 0.50

## TECHNICAL SPECIFICATIONS

### WIRELESS NETWORK LIGHTING CONTROLS

Lightcloud products offer integrated network lighting control for a truly wireless solution that allows you to control RAB's various compatible devices. With RAB's patented Rapid Provisioning technology, devices can be quickly and easily commissioned for residential and commercial applications. Each device can then communicate with other devices in the mesh network. With two Lightcloud systems to choose from, it's easy to implement controls within any application.

DLC system - N1XMLOEATBA (Interior); NHCZ2BIA17L (Exterior)

Learn more at [www.lightcloud.com](http://www.lightcloud.com)

#### Lightcloud Blue (/LCB)

- Utilizes Bluetooth Mesh, eliminating the need for a Gateway or Hub.
- Ideal for applications that need basic wireless control such as ON/OFF, dimming, color tuning, Schedules, and SmartShift.
- Download the Lightcloud Blue mobile app for iOS or Android devices.

#### Lightcloud Enterprise (/LC)

- Utilizes a secure cellular and Zigbee mesh network that requires a Gateway or Hub (sold separately).
- Offers premium features like remote commissioning, demand response, BACnet integration, and more.
- Download the Lightcloud Enterprise mobile app for iOS or Android devices.

### OCCUPANCY SENSORS

**Sensor Type:** Passive Infrared (PIR) or Microwave (MVS)

**Input Voltage:** 12VDC

**Operating Frequency:** 50/60Hz

**Operating Temperature:** -22°F to 104°F (-30°C to 40°C)

**Max Mounting Height:** 9 ft. to 12 ft.

**Detection Range:** 20 ft. diameter at 9 ft. mounting height

### OCCUPANCY SENSORS

**Daylight Sensing:** The sensor will determine to trigger the light(s) on or not based on the daylight threshold level set. Closed loop daylight harvesting with continuous dimming available with Lightcloud Blue. Specify settings using the Lightcloud Blue mobile app.

#### Default Settings:

Motion Sensitivity: High

Brightness when triggered : 100%

Hold time: 20 minutes

Standby to dim: 20%

Standby time: 1 minute

When vacant: Off

#### Daylight: Disabled

**Adjustable Settings:** Settings for Lightcloud Blue-enabled sensors can be adjusted using the mobile app. All other sensors will require MSR1 Remote (sold separately) to adjust the following sensor settings:

### OTHER

#### Warranty

RAB warrants that our LED products will be free from defects in materials and workmanship for a period of five (5) years from the date of delivery to the end user, including coverage of light output, color stability, driver performance and fixture finish. RAB's warranty is subject to all terms and conditions found at [rablighting.com/warranty](http://rablighting.com/warranty).

#### Lifespan

100,000-hour LED lifespan based on IES LM-80 results and TM-21 calculations. 50,000-hour lifespan for the tunable version.

## ACCESSORIES (to be ordered separately)

Image	SKU#	UPC	Description
	MSR1	192552026055	MULTI SENSOR REMOTE CONTROL IP20
	SMKPANEL2X2	019813104973	LPANEL 2X2 SURFACE MOUNTING KIT WHITE
	SMKPANEL2X4	019813295831	LPANEL 2X4 SURFACE MOUNTING KIT WHITE
	RMKPANEL2X2	019813104966	LPANEL 2X2 RECESS ED MOUNTING KIT WHITE
	RMKPANEL2X4	019813104980	LPANEL 2X4 RECESS ED MOUNTING KIT WHITE

Lightcloud Blue, Smartshift, SWISH® Center Basket Troffer

RAB®

DIMENSIONS

Model: 2'X2'  
Weight: 14.0 lbs

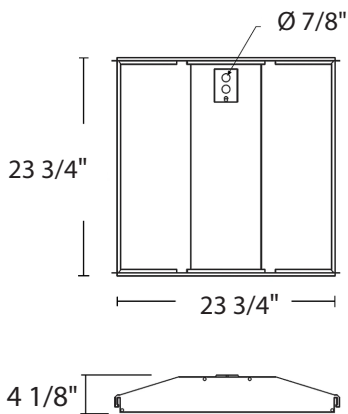

Model: 2'X4'  
Weight: 23.0 lbs

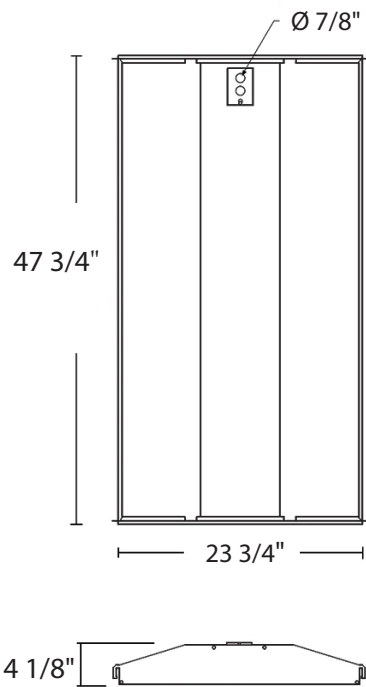

ORDERING MATRIX

SWISHFA w/Selectable CCT

Family	Size / Wattage	Color Temperature	Finish	Driver	Options	Battery Backup
SWISHFA				/D10		
	2X2	2' x 2', 39/29/19W Selectable	BLANK	3500/4000/5000K Adjustable	BLANK	No Option
	2X4	2' x 4', 49/39/29W Selectable	BLANK	White /D10	120-277V, 0-10V Dimming	BLANK /MVS /LC

SWISHFA w/Tunable White

Family	Size / Wattage	Color Temperature	Finish	Driver	Options	Battery Backup
SWISHFA						
	2X2	2' x 2', 40W	BLANK	Tunable White 2700-6500K	BLANK	No Option
	2X4	2' x 4', 50W	BLANK	White BLANK	120-277V /LCB /LCBS /LCBS/MVS	Lightcloud Blue Lightcloud Blue w/PIR Sensor Lightcloud Blue w/MVS Sensor